



12 Owlswood

Salisbury, SP2 8DN

£295,000



A three bedroom semi-detached house quietly tucked away within this small cul-de-sac requiring some cosmetic enhancement. 12 Owlswood is a modern property benefitting from double glazing and gas heating (modern boiler), however, the property could benefit from decorative enhancements – thus giving the new owner the opportunity to personalise. Other benefits include ground floor cloakroom, generous driveway and garage. Located in Ridings Mead the property is very well located for the district hospital, city centre and with open countryside on its doorstep. Offered for sale with vacant possession the property offers a great opportunity to live in this lovely, mature residential setting.



Directions

Proceed to the A354 Coombe Road, turning left at the mini-roundabout signposted District Hospital. Turn right at the next roundabout into Heronswood. Follow Heronswood for a time turning left into Owlswood, number 12 can be found on the right.

Double Glazed Front Door to:

Entrance Hall

Stairs to first floor, double radiator and electric fuses.

Cloakroom

Coloured WC and basin. Radiator and extractor fan.

Sitting/Dining Room 20'6" x 11'9" reducing to 9'4" (6.25m x 3.6m reducing to 2.85m)

Double glazed bay window and door to rear garden. Two double radiators, telephone and television aerial points.

Kitchen 9'0" x 7'6" (2.75m x 2.3m)

Matching wall and base units with worksurface over. Space for oven, fridge/freezer and washing machine. Wall mounted Worcester gas boiler. Inset stainless steel sink unit with mixer taps and tiled splashbacks. Double glazed window to front aspect.

First Floor Landing

Full height airing cupboard housing hot water tank.

Bedroom One 11'5" x 9'4" (3.5m x 2.85m)

Double glazed window to rear aspect. Radiator and television aerial point.

Bedroom Two 8'10" x 9'2" (2.7 x 2.8m)

Double glazed window to rear aspect. Radiator and television aerial point.

Bedroom Three 8'10" x 7'8" (2.71m x 2.35m)

Double glazed window to front aspect. Radiator, television aerial points and access to loft space.

Bathroom

Coloured suite comprising push button WC, pedestal basin and panelled bath with mixer/shower taps. Tiled splashbacks, double radiator, extractor fan, shaver point and obscure double glazed window.

Outside

To the front of the house is a sloping area of lawn with mature ornamental tree. Steps to the front of the property. Driveway to side of the house providing parking for 2-3 cars and pedestrian access to the garden.

Garage (5m x 2.5m)

Up and over door and window to front and double glazed window.

The rear garden has a small paved patio area directly outside the living room, pedestrian access to side. Sloping lawn with mature planting toward the end, enclosed by wooden fencing.

Area Map



Floor Plans

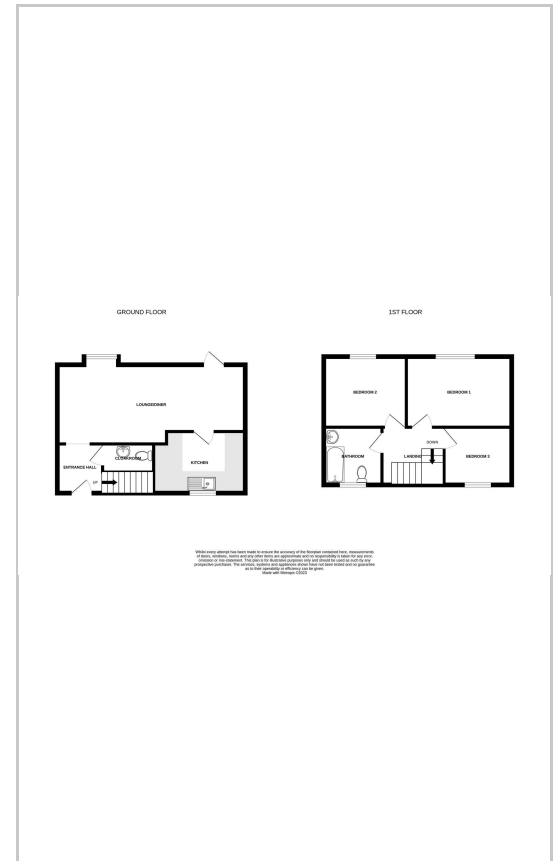

Energy Efficiency Graph

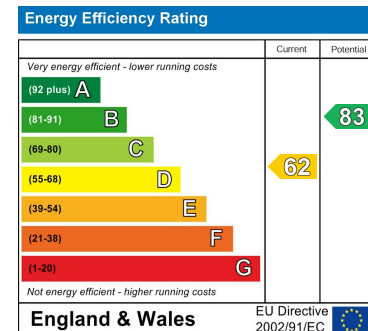

These particulars, whilst believed to be accurate are set out as a general outline only for guidance and do not constitute any part of an offer or contract. Intending purchasers should not rely on them as statements of representation of fact, but must satisfy themselves by inspection or otherwise as to their accuracy. No person in this firm's employment has the authority to make or give any representation or warranty in respect of the property.